

Wide input range
 1:2 ; 1:3

INDUSTRIAL DC/DC Converters Step Down

Stand: 13/08
 100 - 300 Watt
 Series: HSD2
 HSD3

Electrical specifications:

Output voltage accuracy: +/- 3%
 Line regulation: +/- 1%
 Load regulation: +/- 3%
 Efficiency: 91% @48V Vin
 Ambient temperature: -40°C to +71°C

Operating temperature: max. +105°C
 Insulation voltage: none
 Short circuit protection: continuous
 Output ripple & noise: max. 200mVp-p
 Low Voltage Lockout

CAUTION: NO INPUT POLARITY CHANGE ALLOWED!

Part - No.	Input voltage	NO ISOLATION	Output voltage	Output current
HSD2-4524	45V (30- 60V)		Other voltages 24V 24V 24V on request on request	24V
HSD2-4524	45V (30- 60V)	24V		12,5A**
HSD3-8024	80V (40-120V)	24V		4,16A / 6,25A / 8,30A*

Any other output voltages available

* With heatsink 400cm² / 2mm thickness !

**2200µF / 105°C Elco
 at input & output is a must !**

** With proper heatsink to avoid heatsink
 temperatures above +85°C

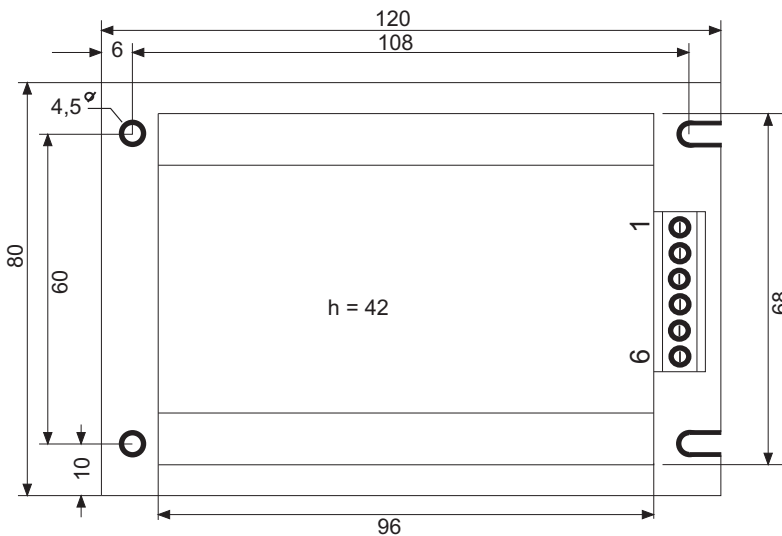

Pin Connections

Pin. NO.	PIN FUNCTION
1	+ INPUT
2	+ INPUT
3	GND
4	GND
5	+ OUTPUT
6	+ OUTPUT

**ALL DIMENSIONS IN MM
 Tolerance +/-0,5mm**

Heatsink & Fixingplate:
 Aluminium 3mm

NOTE: Pin size is 1mm diameter.
 No input polarity change
 allowed !

Specification may be changed without notice
 please contact office for verification

We can offer EMC - Filter
 according to EN55011/22 Class B.